

# NightSky LED™

## LED Outdoor Pole/Arm Mounted Area and Roadway Lighting

MODEL: H140A



### Benefits:

- Instantly lowers your Power Bill (50% – 80%)
- Incredible performance (5 times longer lifespan)
- Saving energy (using 3 times less power than HPS)
- Superior efficiency (Power efficiency over 90%)
- Impressive lighting (Luminous efficacy >90 lm/W)
- Great reliability (**5 years warranty**)
- Green technology (BC Hydro's PowerSmart friendly)
- Recyclable (LED, Aluminum Alloy; **NO** Mercury and **NO** Lead)

### Features:

- Top grade LED chips by **CREE®** (color rendering CRI>74)
- Minimum lifespan of over **50,000 hours** (with 75% luminosity retained)
- Suitable for -40°C – +65°C and 10%~95% humidity environments
- Improved lumen output ratio; over 90 lm/W efficiency
- Non-Image optics; Impact resistant Polycarbonate
- Aluminum alloy heat sinks; weather sealed (IP66); quick replacement
- Reliable high performance, dimmable and programmable drivers by **Philips®**
- Universal Drivers 50/60Hz; Total Harmonic Distortion (THD) <10%
- 120V-277V and 347-480V; Power Factor (PF) >0.98
- Fast to mount/dismount; universal **WAGO®** quick connectors

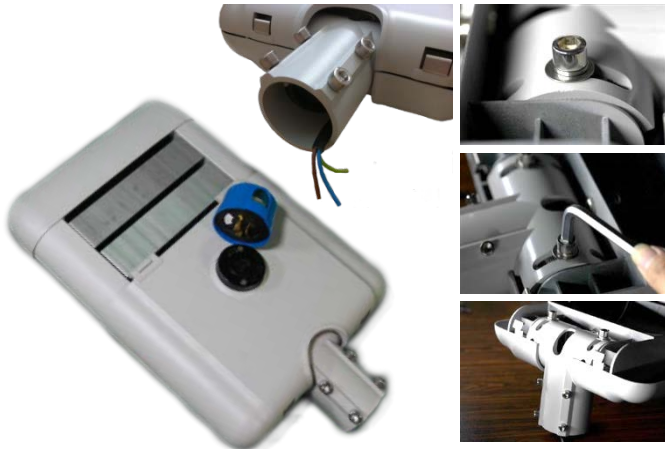
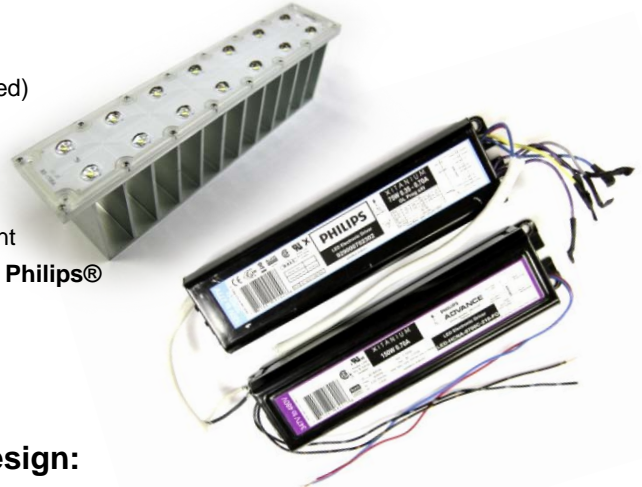

### Design:

- Modular design exposed to environment
- 14 x 2W LEDs per strip; better LED chip cooling
- Open air ventilation; great heat dissipation
- Several housing colors (Grey, Black, and White)
- Various types of light distribution pattern
- Choice of LED light colors (From 3000K to 6500K)
- Unique arrangement of rotating arm; fast securing
- Adjustable angle from -30° to +90°
- Easy mounting on posts of up to OD 65mm (2.56")
- Various accessories; Photocells and Bird Spikes

LED Consumption	280W
System Consumption	299W
Total Flux	> 27,105 lm
Replacement for	>1000W MH
Net Weight	32.7 lb
Product size AxBxC	41" x 14" x 4"

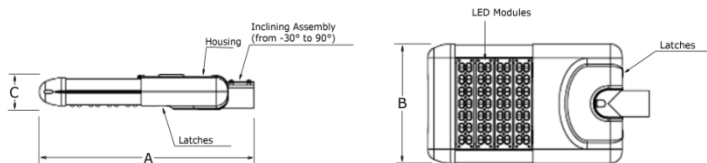

## BDS – H140A – ZZ – OT – CC – HC

MODEL	POWER (ZZ)	OPTICS (OT)	COLOR (CC)	BODY (HC)	ACCESSORY
 HxxxA (xxx-Number of LEDs)	Z1 (120 - 277V)	A3 (Type III, Long)	WW (Warm White)	RA (Raw Grey)	(None)
	Z3 (347 - 480V)	A2 (Type II, Medium)	PW (Pure White)	BK (Black)	PC (Photocell)
		T3 (Type I, Short)	CW (Cool White)	WT (White)	
		T4 (Type I, Medium)			

Scan the above QR Code to get more information about the Products, IES Files and Photometric Reports. All information is subject to change without notice. © are Registered Trademarks of their respective owners. ™NightSky LED is the Trademark of BDS Industrial Solutions Inc. ©2012 BDS Industrial Solutions Inc. All rights reserved. Rev. 08/12

**BDS Industrial Solutions Inc.**  
209 – 8988 Fraserton Court, Burnaby, BC V5J 5H8

T: +1 (604) 435-1879  
info@bdsindustrial.com

F: +1 (866) 336-3986  
www.bdsindustrial.com